

DUCATI PANIGALE V4 '20- / V4 R '19-'20 / V4 S '20-

REF 3759

R - RACER SCREEN



1 Person



45 min



MEDIUM



TORX T° 7



ALLEN N° 3
N° 4

ID	PIEZA/PART	DESCRIPCIÓN	DESCRIPTION	QTY	REF
1		Cúpula R-Racer	R-Racer screen	1	3759F/H/R/W/NM3

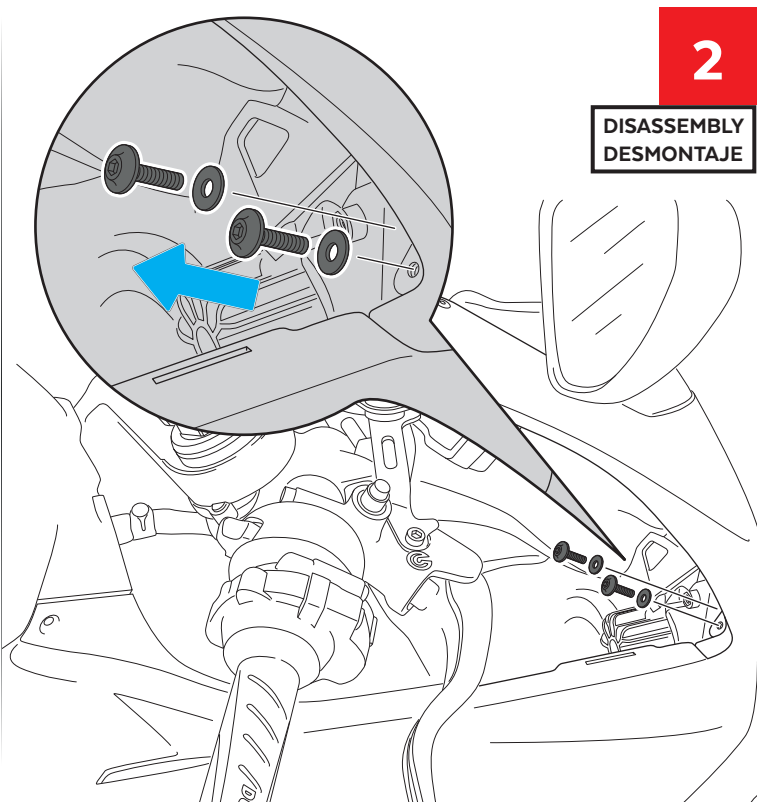
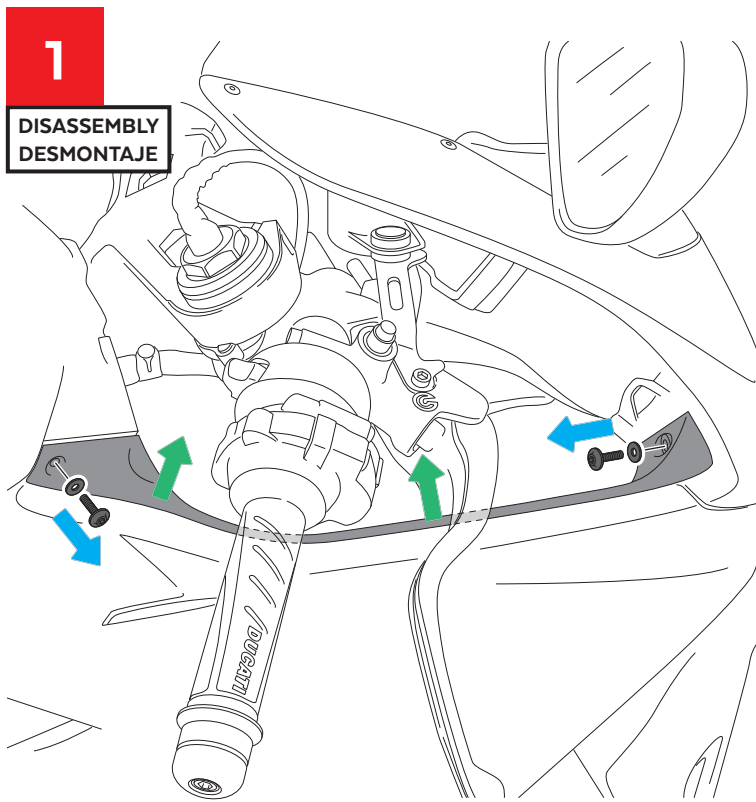

DUCATI PANIGALE V4 '20- / V4 R '19-'20 / V4 S '20-

INSTRUCCIONES DE MONTAJE - MOUNTING INSTRUCTIONS - MONTAGEANLEITUNG

3

DISASSEMBLY
DESMONTAJE

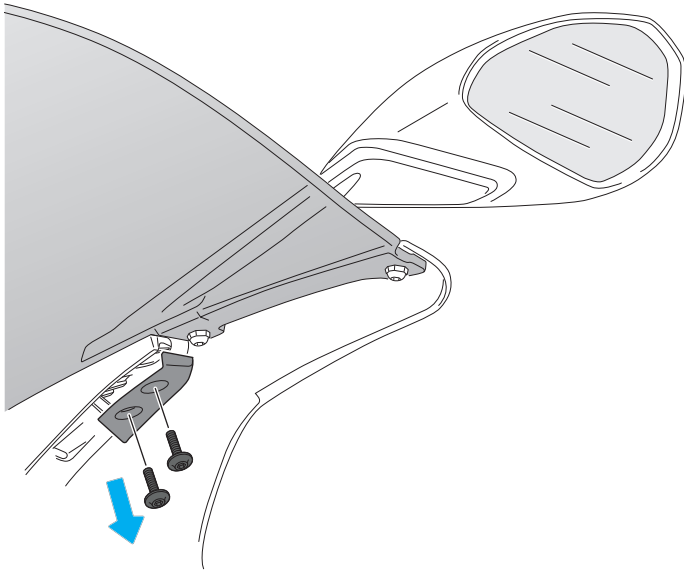

4

DISASSEMBLY
DESMONTAJE

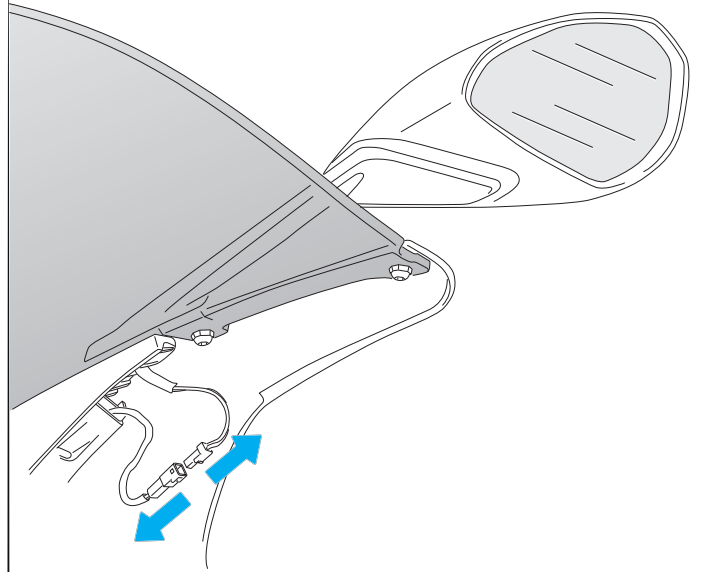

5

DISASSEMBLY
DESMONTAJE

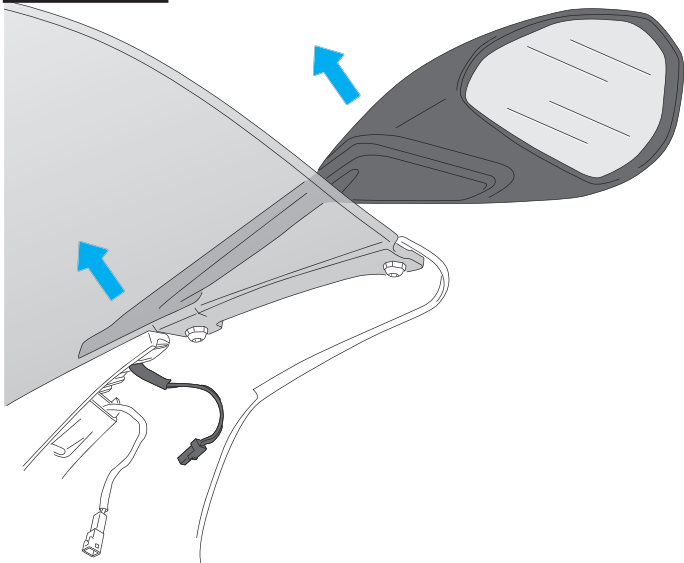

6

DISASSEMBLY
DESMONTAJE

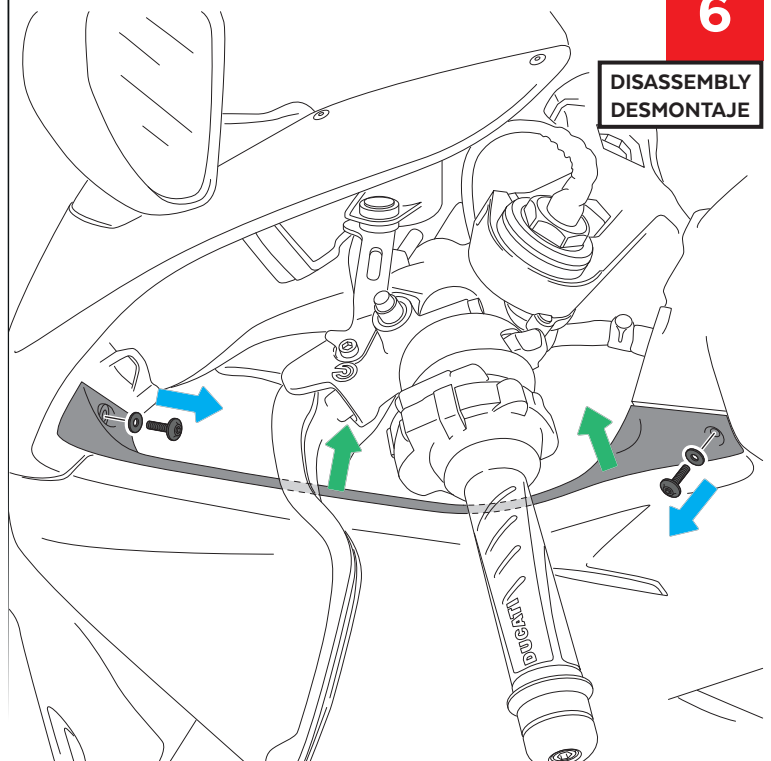

DUCATI PANIGALE V4 '20- / V4 R '19-'20 / V4 S '20-

INSTRUCCIONES DE MONTAJE - MOUNTING INSTRUCTIONS - MONTAGEANLEITUNG

7

DISASSEMBLY
DESMONTAJE

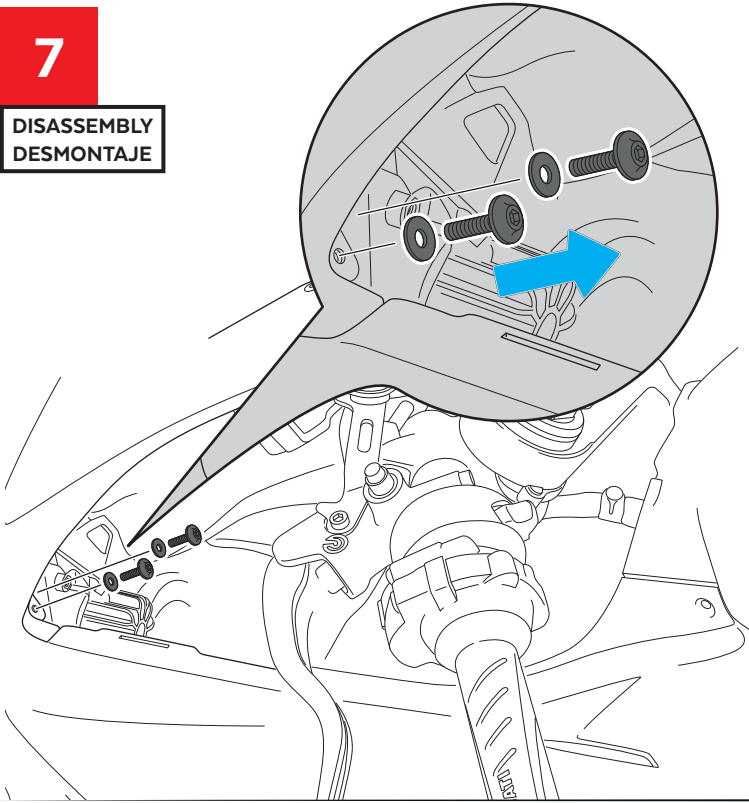

8

DISASSEMBLY
DESMONTAJE

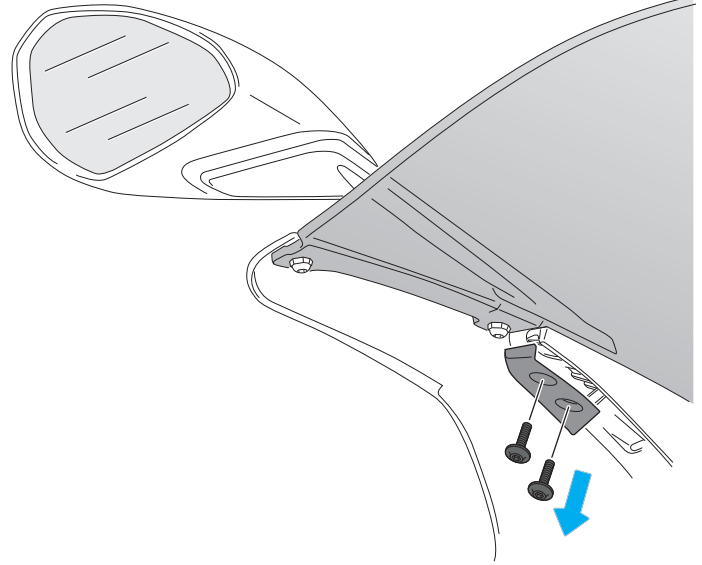

9

DISASSEMBLY
DESMONTAJE

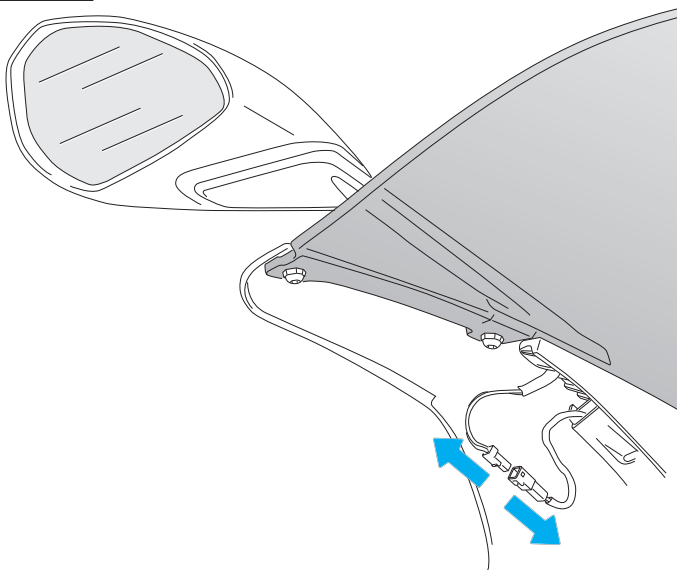

10

DISASSEMBLY
DESMONTAJE

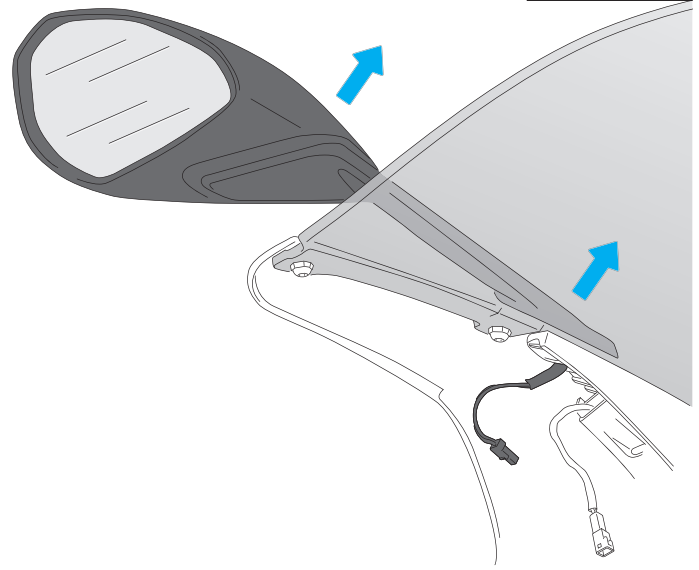

DUCATI PANIGALE V4 '20- / V4 R '19-'20 / V4 S '20-

INSTRUCCIONES DE MONTAJE - MOUNTING INSTRUCTIONS - MONTAGEANLEITUNG

11

DISASSEMBLY
DESMONTAJE

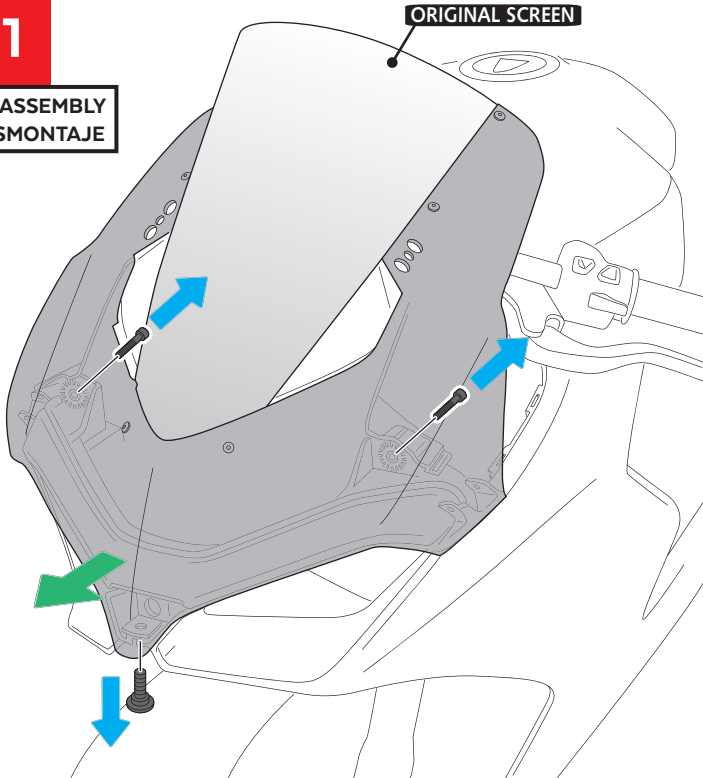

12

DISASSEMBLY
DESMONTAJE

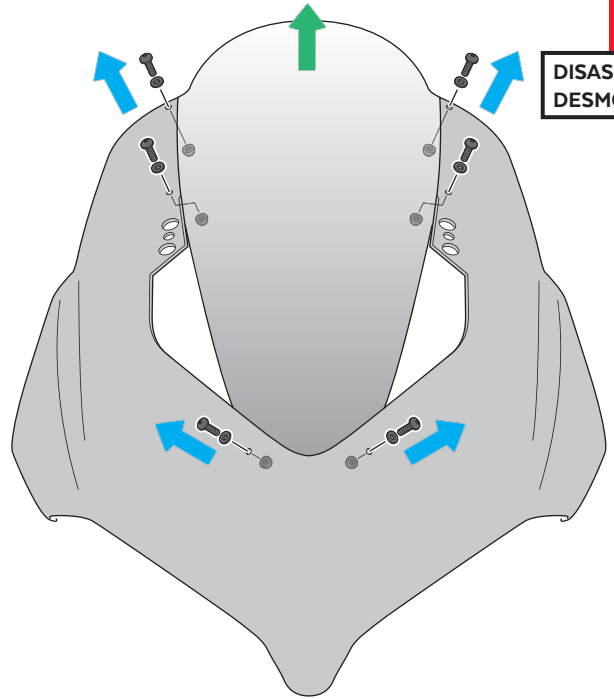

13

ASSEMBLY
MONTAJE

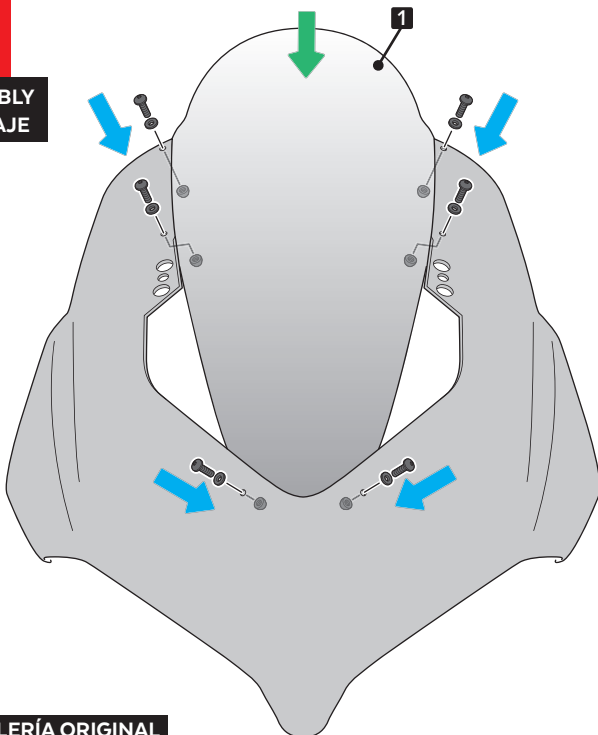

TORNILLERÍA ORIGINAL
ORIGINAL SCREWS

PARA FINALIZAR EL MONTAJE DEL CARENADO, VOLVER A COLOCAR LA TORNILLERÍA SEGÚN VIÑETAS DE LA 11 A LA 1.

IN ORDER TO FINISH THE ASSEMBLY OF THE FAIRING, PLACE THE SCREWS BACK ON ACCORDING TO DRAWINGS 11 TO 1.