

# HONDA CBR600RR '24-

## M O U N T I N G I N S T R U C T I O N S

REF 22192

FRONTAL SPOILER GP



ID	PIEZA/PART	DESCRIPCIÓN	DESCRIPTION	QTY	REF
1		Alerón frontal GP izquierdo	Left frontal spoiler GP	1	22192J/CM3
2		Alerón frontal GP derecho	Right frontal spoiler GP	1	22192J/CM3
3		Soporte izquierdo ( L )	Left support ( L )	1	SOPOR2P7-L22192
4		Soporte derecho ( R )	Right support ( R )	1	SOPOR2P7-R22192
5		Tuerca de clip M5	M5 clip nut	4	TUERCA-TRT-M5--
6		Tuerca M5 DIN 6923	M5 DIN 6923 Nut	4	TUERC-D6923-255
7		Casquillo con valona Ø15x Ø9 x7,5	Bush with flange Ø15x Ø9 x7,5	2	CASQUI-1A---324
8		Silentblock Ø18x Ø9 xØ11 x7,5	Ø18x Ø9 xØ11 x7,5 silentblock	2	SILENBGONE--064
9		Tornillo Allen M5x35 Ø11 ISO 7380	M5x35 Ø11 ISO 7380 Allen screw	2	TORNI-I7380-805
10		Casquillo Ø8,5x Ø13x 12	Ø8,5x Ø13x 12 Arrowhead	2	CASQUI-M----769
11		Tornillo Allen M5x20 Ø11 ISO 7380	M5x20 Ø11 ISO 7380 Allen screw	2	TORNI-I7380-730
12		Casquillo Ø8,5x Ø13x 6	Ø8,5x Ø13x 6 Arrowhead	2	CASQUI-----776
13		Tornillo M5x16 DIN7991	M5x16 DIN7991 Allen screw	4	TORNI-D7991-867
14		Arandela de goma Ø4,5 x Ø11 x 2mm	Ø4,5 x Ø11 x 2mm Rubber washer	4	ARAND-EPDM--722
15		Tapón tornillo M5 DIN7991	M5 DIN7991 screw cap	4	TAPON-----92

# HONDA CBR600RR '24-

INSTRUCCIONES DE MONTAJE - MOUNTING INSTRUCTIONS - MONTAGEANLEITUNG

**1**

**DISASSEMBLY  
DESMONTAJE**

Se muestra el montaje del lado izquierdo a modo de ejemplo, realizar los mismos pasos para el montaje del lado derecho.  
The left side assembly is shown as an example, so the same steps can be performed for the right side assembly.

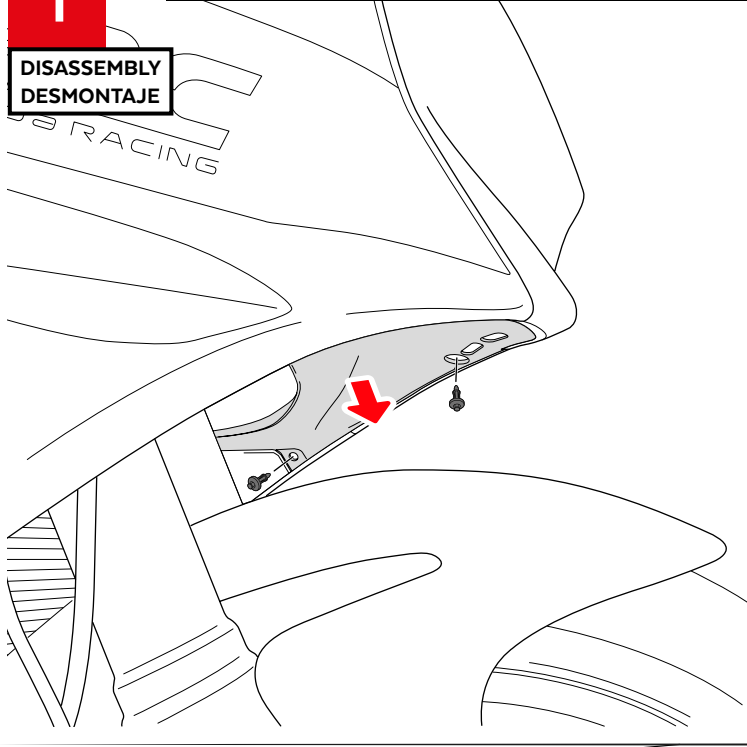

**2**

**ASSEMBLY  
MONTAJE**

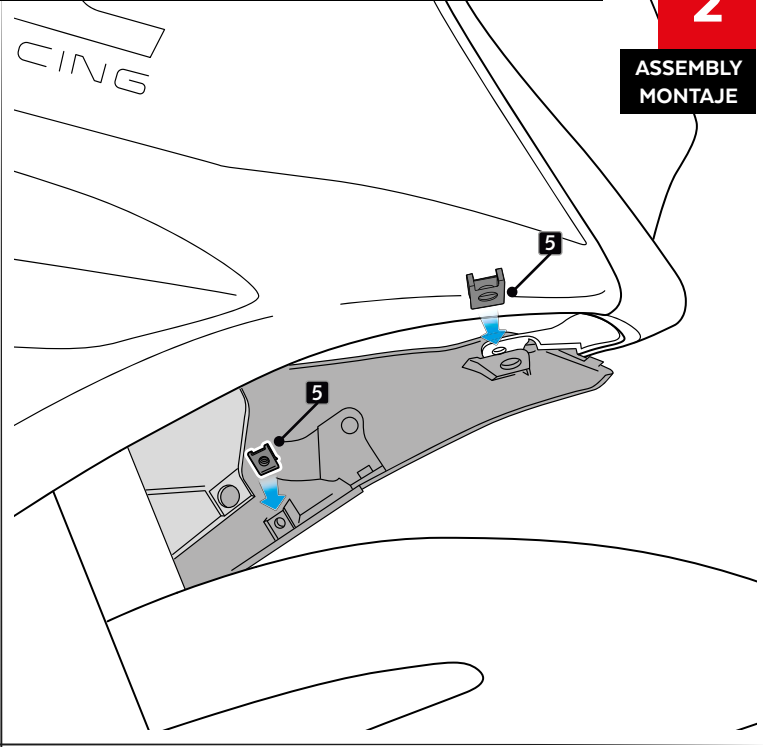

**3**

**ASSEMBLY  
MONTAJE**

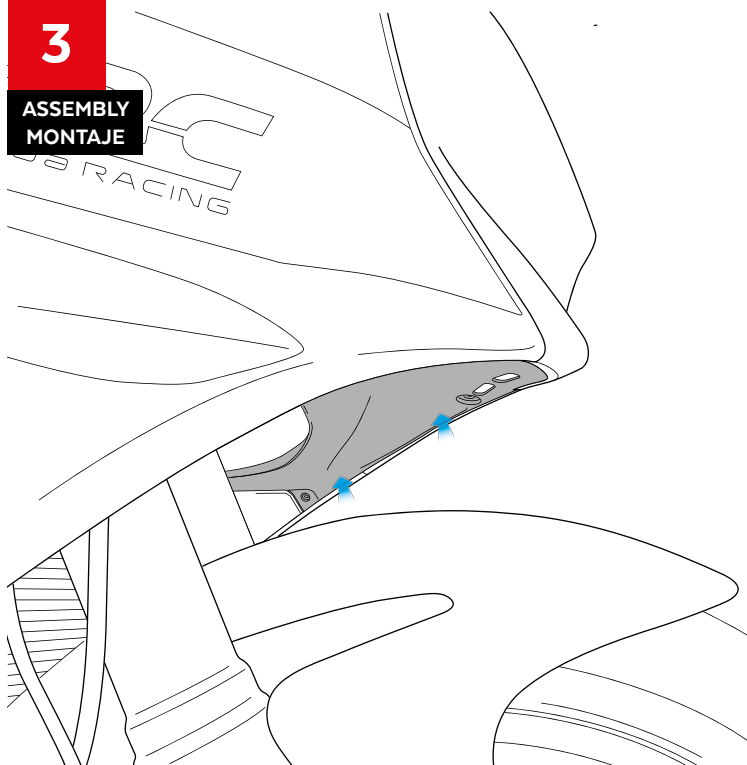

**4**

**PREASSEMBLY  
PREMONTAJE**

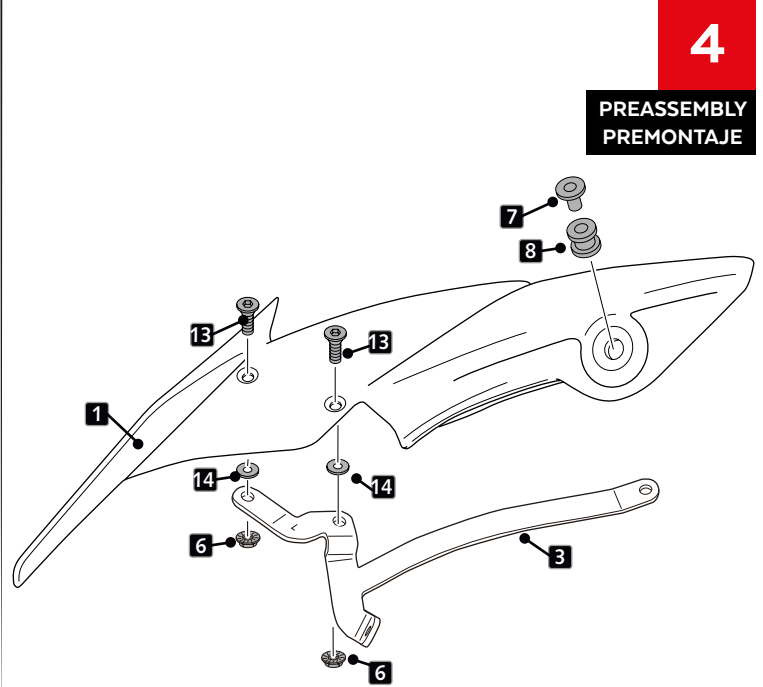

**DO NOT TIGHTEN ID.13 SCREWS AND ID.6 NUTS**

# HONDA CBR600RR '24-

INSTRUCCIONES DE MONTAJE - MOUNTING INSTRUCTIONS - MONTAGEANLEITUNG

**5**

ASSEMBLY  
MONTAJE

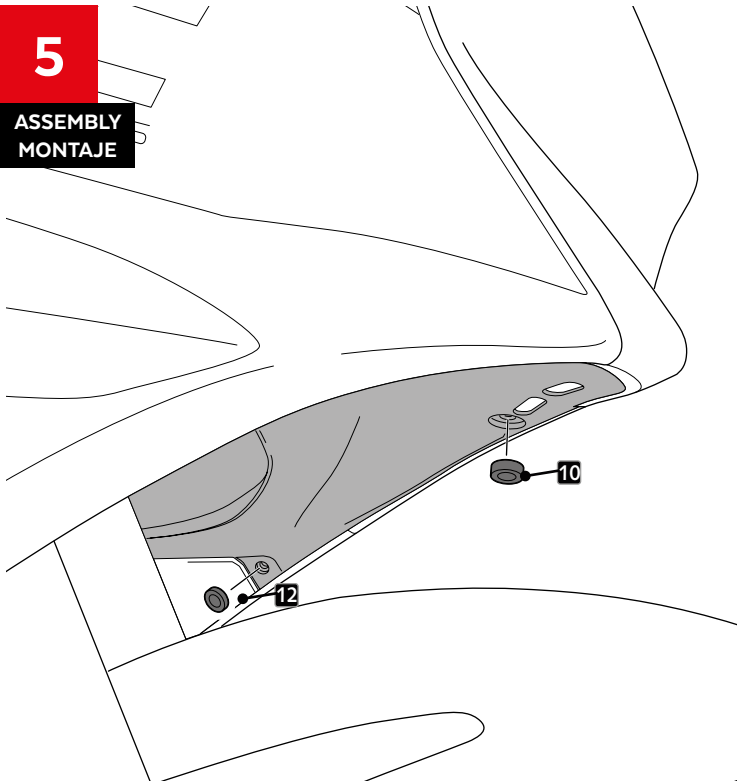

**6**

ASSEMBLY  
MONTAJE

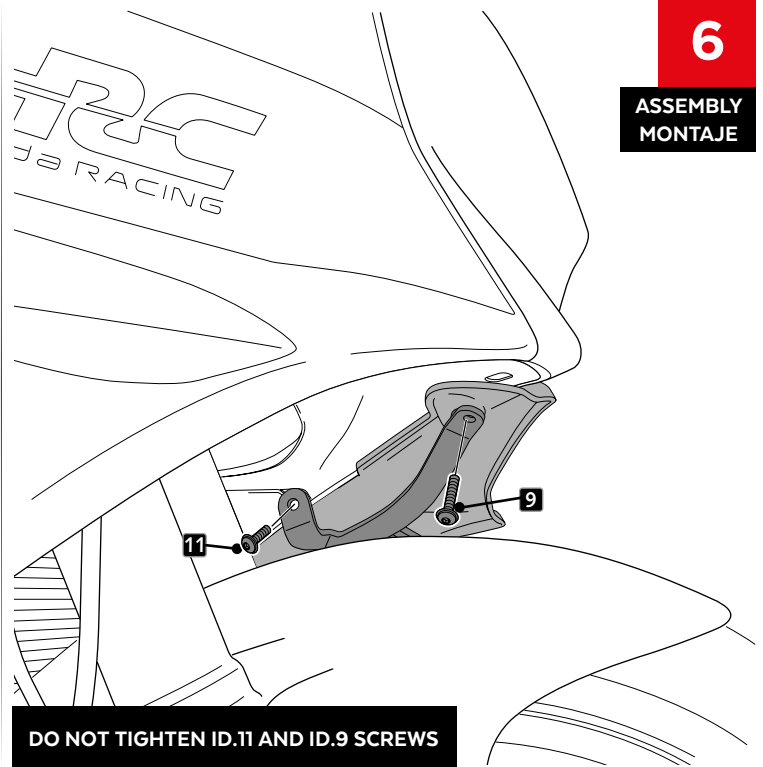

DO NOT TIGHTEN ID.11 AND ID.9 SCREWS

**7**

ASSEMBLY  
MONTAJE

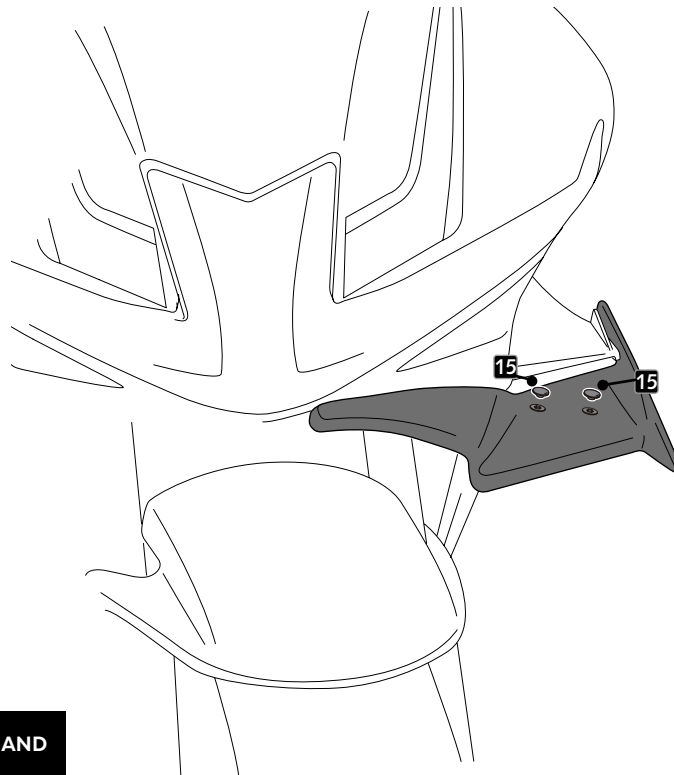

ADJUST THE POSITION OF SPOILERS AND  
TIGHTEN ID.13, ID.11 AND ID.9 SCREWS